

# GPX 42

## Planetary Gearhead Ø42 mm

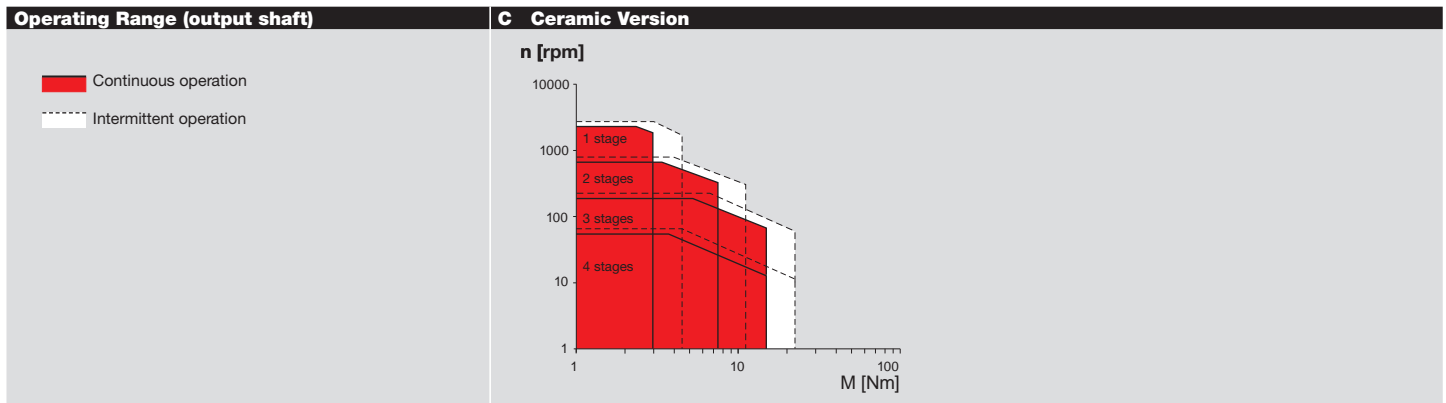

Key Data		C Ceramic Version
Max. transmittable power	W	580
Max. continuous torque	Nm	15.0
Max. continuous input speed	rpm	8000
Ambient temperature	°C	-40 ... +100
Bearing at output		Ball bearing



Specifications		C Ceramic Version			
		1	2	3	4
Number of stages		1	2	3	4
Max. transmittable power (continuous)	W	580	240	100	20
Max. transmittable power (intermittent)	W	725	300	125	25
Max. continuous torque	Nm	3.0	7.5	15.0	15.0
Max. intermittent torque	Nm	4.5	11.3	22.5	22.5
Max. continuous input speed	rpm	8000	8000	8000	8000
Max. intermittent input speed	rpm	10000	10000	10000	10000
Max. efficiency	%	90	81	72	64
Average backlash no load	°	0.6	0.8	1.0	1.0
Max. axial load (dynamic)	N	150	150	150	150
Max. radial load, 12 mm from flange	N	120	240	360	360
Gearhead length L1	mm	37.4	51.9	66.4	80.9
Weight	g	260	360	460	560

Configuration		C Ceramic Version			
		1	2	3	4
Number of stages		1	2	3	4
Reduction	X:1	3.5, 4.3	12, 15, 19, 21, 26	43, 53, 66, 74, 81, 113, 126, 156	150, 186, 230, 257, 285, 319, 353, 394, 441, 488, 546, 676, 756, 936
Version		Ceramic Version			
Flange		Standard flange/configurable flange			
Shaft		Length/feather key			

maxon Modular System		Page	Dimensions	M 1:2
maxon DC motor	Number of stages			
DCX 35 L	1-4	83		

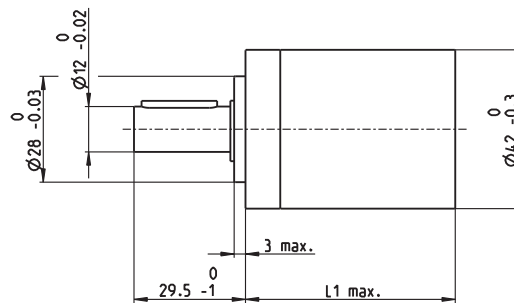

xdrives.maxonmotor.com