

GPX 16 SPEED

Planetary Gearhead Ø16 mm

Sterilizable

NEW



maxon X drives

| Key Data | Without shaft seal* | With shaft seal* |
|-----------------------------|---------------------|------------------|
| Max. transmittable power | W 42 (5.2) | 42 (5.2) |
| Max. continuous torque | Nm 0.11 (0.2) | 0.11 (0.2) |
| Max. continuous input speed | rpm 50000 | 50000 |
| Ambient temperature | °C -10 ... +135 | -10 ... +135 |
| Bearing at output | Ball bearing | Ball bearing |

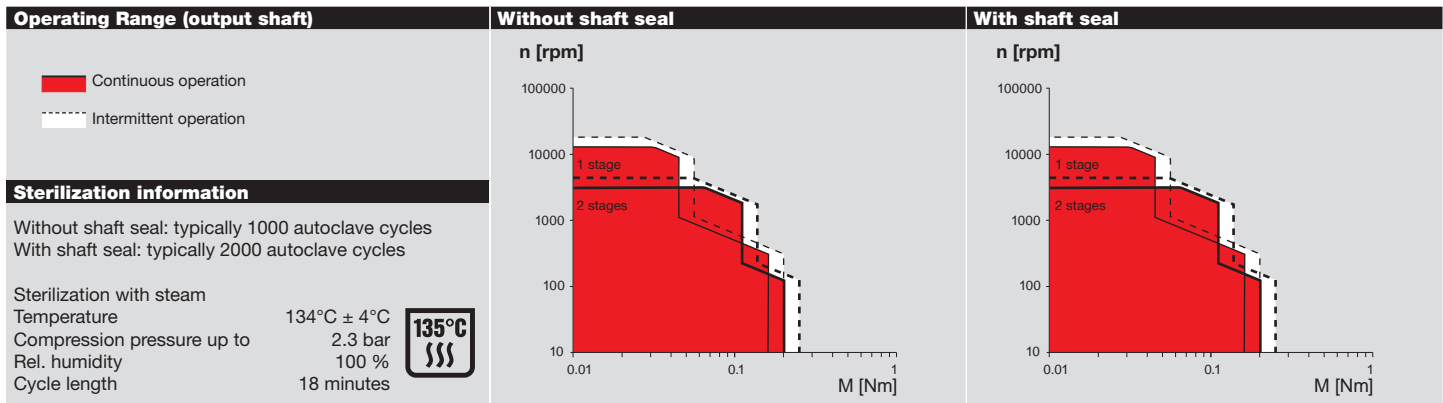

| Specifications | Without shaft seal* | | With shaft seal* | |
|---------------------------------------|---------------------|--------------|------------------|--------------|
| | 1 | 2 | 1 | 2 |
| Number of stages | | | | |
| Max. transmittable continuous power | W 42 (5.2) | 21 (2.6) | 42 (5.2) | 21 (2.6) |
| Max. transmittable intermittent power | W 52 (6.5) | 25 (3.3) | 52 (6.5) | 25 (3.3) |
| Max. continuous torque | Nm 0.045 (0.16) | 0.11 (0.20) | 0.045 (0.16) | 0.11 (0.20) |
| Max. intermittent torque | Nm 0.055 (0.20) | 0.140 (0.25) | 0.055 (0.20) | 0.140 (0.25) |
| Max. continuous input speed | rpm 50000 | 50000 | 50000 | 50000 |
| Max. intermittent input speed | rpm 70000 | 70000 | 70000 | 70000 |
| Max. efficiency | % 85 | 80 | 85 | 80 |
| Average backlash no load | ° 1.4 | 1.6 | 1.4 | 1.6 |
| Max. axial load (dynamic) | N 30.0 | 30.0 | 30.0 | 30.0 |
| Max. radial load, 5 mm from flange | N 25.0 | 35.0 | 15.0 | 20.0 |
| Gearhead length L1 | mm 27.7 | 35.1 | 35.3 | 42.7 |
| Weight | g 27 | 35 | 37 | 45 |

| Configuration | Without shaft seal | | With shaft seal | |
|------------------|------------------------------------|------------------------|-----------------|------------------------|
| | 1 | 2 | 1 | 2 |
| Number of stages | | | | |
| Reduction | X:1 3.9, 5.3, 6.6 | 16, 21, 26, 28, 35, 44 | 3.9, 5.3, 6.6 | 16, 21, 26, 28, 35, 44 |
| Version | Without shaft seal/With shaft seal | | | |
| Flange | Standard flange | | | |
| Shaft | Length/flat face/cross hole | | | |

| maxon Modular System | Page | Dimensions | M 1:1 |
|----------------------|------------------|------------|-------|
| maxon EC motor | Number of stages | | |
| ECX SPEED 16 M | 1-2 | 96-97 | |
| ECX SPEED 16 L | 1-2 | 98-99 | |

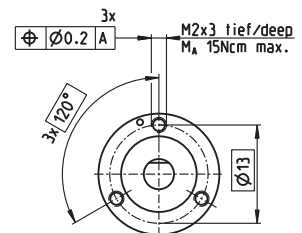
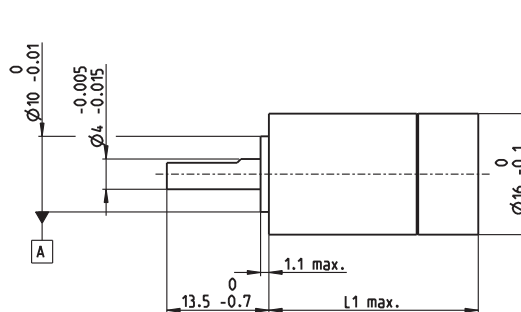

xdrives.maxonmotor.com

*Values in parentheses apply in case of reduced speed (according to diagram).