

Spur Gearhead GS 16 V $\varnothing 16$ mm, 0.06–0.1 Nm

Reinforced

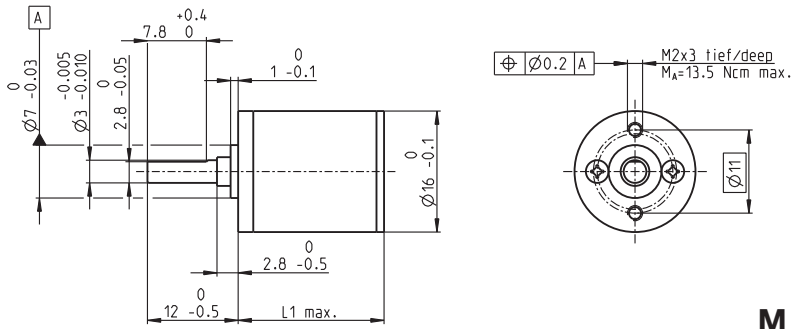

M 1:1

Technical Data

Spur Gearhead	straight teeth
Output shaft	stainless steel, hardened
Bearing at output	preloaded ball bearings
Radial play, 6.5 mm from flange	max. 0.02 mm
Axial play at axial load	< 5 N 0 mm > 5 N max. 0.05 mm
Max. axial load (dynamic)	5 N
Max. force for press fits	5 N
Max. continuous input speed	8000 rpm
Recommended temperature range	-15...+100°C
Extended range as option	-40...+100°C
Number of stages	2 3 4 5 6 7
Max. radial load, 6.5 mm from flange	10 N 15 N 20 N 22 N 22 N 22 N

maxon gear

- Stock program
- Standard program
- Special program (on request)

Part Numbers

	235066	235070	235073	235076	235079	235082
Gearhead Data						
1 Reduction	6.4:1	22:1	76:1	261:1	900:1	3101:1
2 Absolute reduction	403/63	12493/567	387283/5103	12005773/45927	372178963/413343	11537547853/3720087
3 Max. motor shaft diameter mm	1.5	1.5	1.5	1.5	1.5	1.5
Part Numbers	235068	235071	235074	235077	235080	235083
1 Reduction	9.1:1	31:1	108:1	371:1	1278:1	4402:1
2 Absolute reduction	899/99	27869/891	863939/8019	26782109/72171	830245379/649539	25737606749/5845851
3 Max. motor shaft diameter mm	1.5	1.5	1.5	1.5	1.5	1.5
Part Numbers	235069	235072	235075	235078	235081	235084
1 Reduction	12:1	41:1	141:1	485:1	1670:1	5752:1
2 Absolute reduction	961/81	29791/729	923521/6561	28629151/59049	887503681/531441	27512614111/4782969
3 Max. motor shaft diameter mm	1	1	1	1	1	1
4 Number of stages	2	3	4	5	6	7
5 Max. continuous torque Nm	0.06	0.06	0.10	0.10	0.10	0.10
6 Max. intermittent torque at gear output Nm	0.15	0.15	0.30	0.30	0.30	0.30
12 Direction of rotation, drive to output	=	≠	=	≠	=	≠
7 Max. efficiency %	81	73	66	59	53	48
8 Weight g	13.8	14.5	15.8	17.0	17.9	18.5
9 Average backlash no load °	1.0	1.0	1.2	1.2	1.5	1.5
10 Mass inertia gcm ²	0.0057	0.0052	0.0035	0.0032	0.0032	0.0032
11 Gearhead length L1 mm	14.3	17.3	19.3	21.3	23.3	25.3



maxon Modular System									
+ Motor	Page	+ Sensor/Brake	Page	Overall length [mm] = Motor length + gearhead length + (sensor/brake) + assembly parts					
A-max 16	193-196			39.8	42.8	44.8	46.8	48.8	50.8
A-max 16	194/196 MR		388/390	44.8	47.8	49.8	51.8	53.8	55.8
A-max 16	194/196 MEnc 13		409	47.9	50.9	52.9	54.9	56.9	58.9