

Encoder 6-8 OPT 128 CPT, 3 Channels

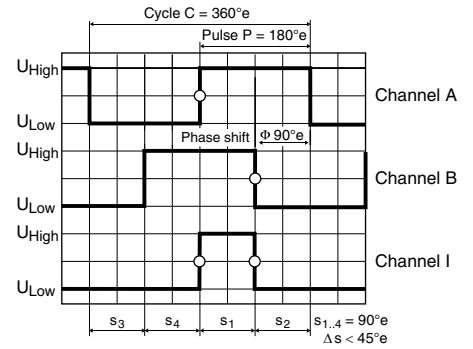

Direction of rotation cw (definition cw p. 150)

- Stock program
- Standard program
- Special program (on request)

Part Numbers
502807

| Type (provisional) | |
|--------------------------------|-------|
| Counts per turn | 128 |
| Number of channels | 3 |
| Max. operating frequency (kHz) | 64 |
| Max. speed (rpm) | 60000 |



| maxon Modular System | | | | | | |
|----------------------|------|-----------------------|---------|---------|------|--------------------------------------|
| + Motor | Page | + Gearhead | Page | + Brake | Page | Overall length [mm] / • see Gearhead |
| EC 6, 1.5 W | 236 | | | | | 23.4 |
| EC 6, 1.5 W | 236 | GP 6, 0.002 - 0.03 Nm | 311 | | | • |
| EC 6, 1.5 W | 236 | GP 6 S | 361-362 | | | • |
| EC 6, 2.0 W | 237 | | | | | 23.4 |
| EC 6, 2.0 W | 237 | GP 6, 0.002 - 0.03 Nm | 311 | | | • |
| EC 6, 2.0 W | 237 | GP 6 S | 361-362 | | | • |

| Technical Data | |
|---------------------------------|----------------------------|
| Supply voltage V_{CC} | 3 - 6 V |
| Phase shift Φ | $90^\circ \pm 45^\circ e$ |
| Index pulse width | $90^\circ \pm 45^\circ e$ |
| Operating temperature range | -20...+85 °C |
| Moment of inertia of code wheel | $\leq 0.001 \text{ gcm}^2$ |
| Output current per channel | $\leq 5 \text{ mA}$ |

| Pin Allocation | |
|----------------|---------------------|
| 1 | Motor + W1 |
| 2 | Motor - W2 |
| 3 | NC W3 |
| 4 | GND GND |
| 5 | V_{CC} V_{CC} |
| 6 | Channel A Channel A |
| 7 | Channel B Channel B |
| 8 | Channel I Channel I |
| 9 | NC NC |
| 10 | NC NC |
| 11 | NC NC |
| 12 | NC NC |

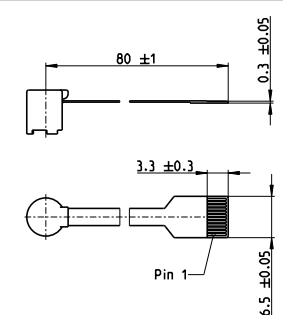

Compatible connector: Molex 52745-0697, Tyco 1-1734839-4
Adapter: 498157

